

particularly described in a Plat accompanying this
 and together with all and singular the rights
 interests Hereditaments and appurtenances to the said
 premises belonging or in any wise incident or appertaining
 to have and to hold all and singular the premises before
 mentioned unto the said Saml. A. Huff her heirs & assigns
 forever And I do hereby bind my heirs executors & administrators
 in warrant and firm defend all and singular the said
 premises unto the said Saml. A. Huff her heirs & assigns
 against myself and my heirs & any other person whomsoever
 lawfully claiming or to claim the same or any part thereof
 Witness our hands and seal this 29 December in the year of our
 Lord one thousand eight hundred and seventy three and
 in the ninth year of the Independence of the United
 States of America Signed Sealed and Delivered in the presence
 of Mary E. Pallard
 S. A. Huff

I personally appeared before
 me Mary E. Pallard and made
 Greenville County South that she Saml. A. Huff
 sign seal and deliver the above conveyance for the use
 and purposes therein mentioned and that she with P. D.
 Huff in the presence of each other witnessed the due
 execution thereof. Sworn to before me this 29 day of December
 1873 P. D. Huff
 Mary E. Pallard
 Notary Public Entered in the auditor office
 Dec 7 Jan 1874

232

Mary Howell & co Deed	The State of South Carolina Know all men by these presents that we Mary Howell and J. H. Elbreath of Greenville county in the State aforesaid in consideration of six hundred dollars to us paid by R. M. Nelson of Greenville County in the State aforesaid have granted Bargain sold and released and by these presents do grant Bargain sell and release unto the said R. M. Nelson all that lot or parcel of land situate & lying on the Greenville & Columbia Rail Road at Grove Station in Greenville County containing three acres and having the following limits & bounds to wit commencing at a stake near the spring thence N 79° W 72 1/2 to a stake in the road thence S 2 E 58 1/2 to a stake thence S 84 E 4 25 to a stake thence N 19 E 5 15 to the Beginning a plat whereof is hereto attached and made a part of this and this being a portion of a lot or tract of land conveyed by Dr M. S. Howell to J. H. Howell and by J. H. Howell to J. H. Elbreath & J. H. Elbreath & recorded in Book A Page 554 and by the said J. H. Elbreath to Mary E. Howell record in Book D D page 116 Together with all and singular the rights interests Hereditaments & appurtenances
--------------------------	---

to the said premises belonging or in any wise incident or
 appertaining to have and to hold all and singular the premises
 before mentioned unto the said R. M. Nelson his heirs & assigns
 forever And we do hereby bind ourselves our heirs executors and
 administrators to warrant and firm defend all and singular
 the said premises unto the said R. M. Nelson his heirs & assigns
 against me and our heirs and any other person whomsoever
 lawfully claiming or to claim the same or any part thereof
 Witness our hands & seals this twentieth day of October in the
 year of our Lord one thousand eight hundred & seventy three
 and in the ninth year of the Independence of the United
 States of America Signed Sealed and Delivered in the presence
 of J. W. Taylor
 W. E. Carlo
 M. A. Hamill
 J. H. Elbreath

I personally appeared before me
 J. W. Taylor & made oath that he saw
 M. A. Hamill & J. H. Elbreath sign seal
 & deliver the above conveyance for the use & purposes therein
 mentioned and that he with W. E. Carlo in the presence of
 each other witnessed the due execution thereof
 Sworn to before me this 16 day of October 1873
 W. E. Carlo Notary Public
 J. W. Taylor
 Recorded 30 December 1873
 Entered in the auditor office
 This and was delivered to me as an exew and in presence
 of the agreement of the parties I have delivered it this day 30
 December 1873
 W. E. Carlo

10 chains per inch

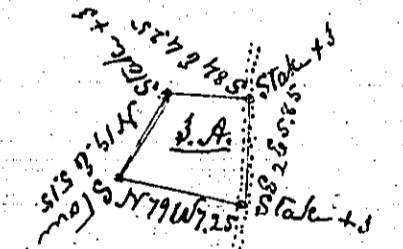

Persuant to the request of Robert Nelson I have surveyed
 and measured a center tract or lot of Land at Grove Station
 Greenville County on Greenville & Columbia Railroad and
 find it to contain three Acres having such shape and
 marks as the above plat more fully represent Surveyed
 October the 15 1873
 J. J. Richardson
 Rec 30 December 1873

233

D. A. Huff Deed	The State of South Carolina Know all men by these presents that I Lewis A. Huff of Greenville County in the State aforesaid in consideration of Five thousand (5000) Dollars to me paid by James W. Huff of Greenville County in the State aforesaid have granted Bargain sold and released and by these presents do grant Bargain sell and release unto the said James W. Huff a certain lot or tract of land and
--------------------	--